

FORM NO 1.

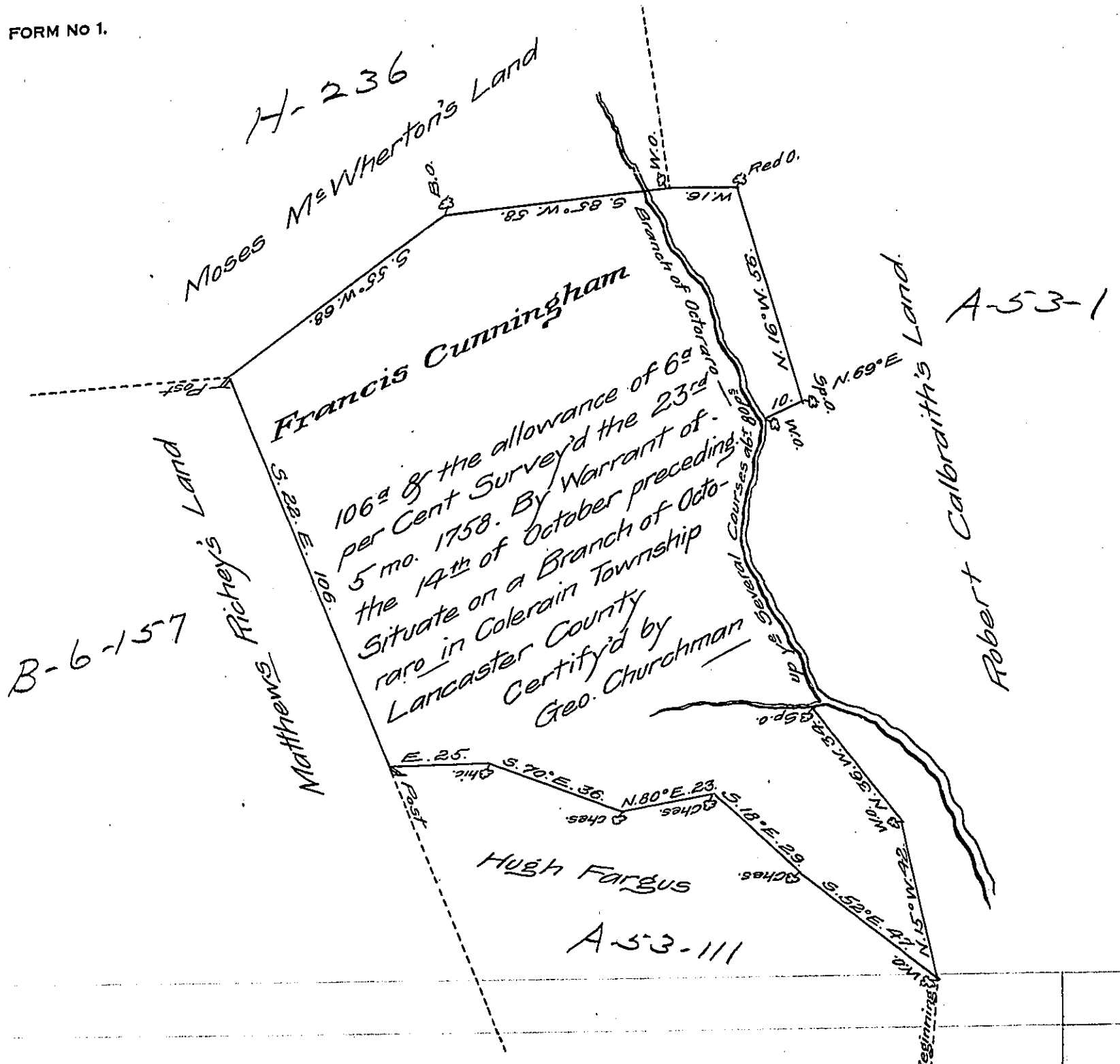

This Survey Begins at a White Oak Corner of Hugh Fergus his Survey & Runs thence by Robert Calbraith's Land N. 15° W. 42 p^s to a W.O. & N. 36° W. 34 p^s to a Span. Oak on the South Side of a Small Branch, thence down the said Branch about 8 p^s to the Mouth thereof & up a Larger Branch the several Courses about 80 p^s to a white oak &c^s — as per Draught.

IN TESTIMONY that the above is a copy of the original remaining on file in the Department of Internal Affairs of Pennsylvania, made conformably to an Act of Assembly approved the 16th day of February, 1833, I have hereunto set my Hand and caused the Seal of said Department to be affixed at Harrisburg, this twelfth day of December 1907.

Henry Houck
Secretary of Internal Affairs.